

WELBRO

PIPE & COUPLING

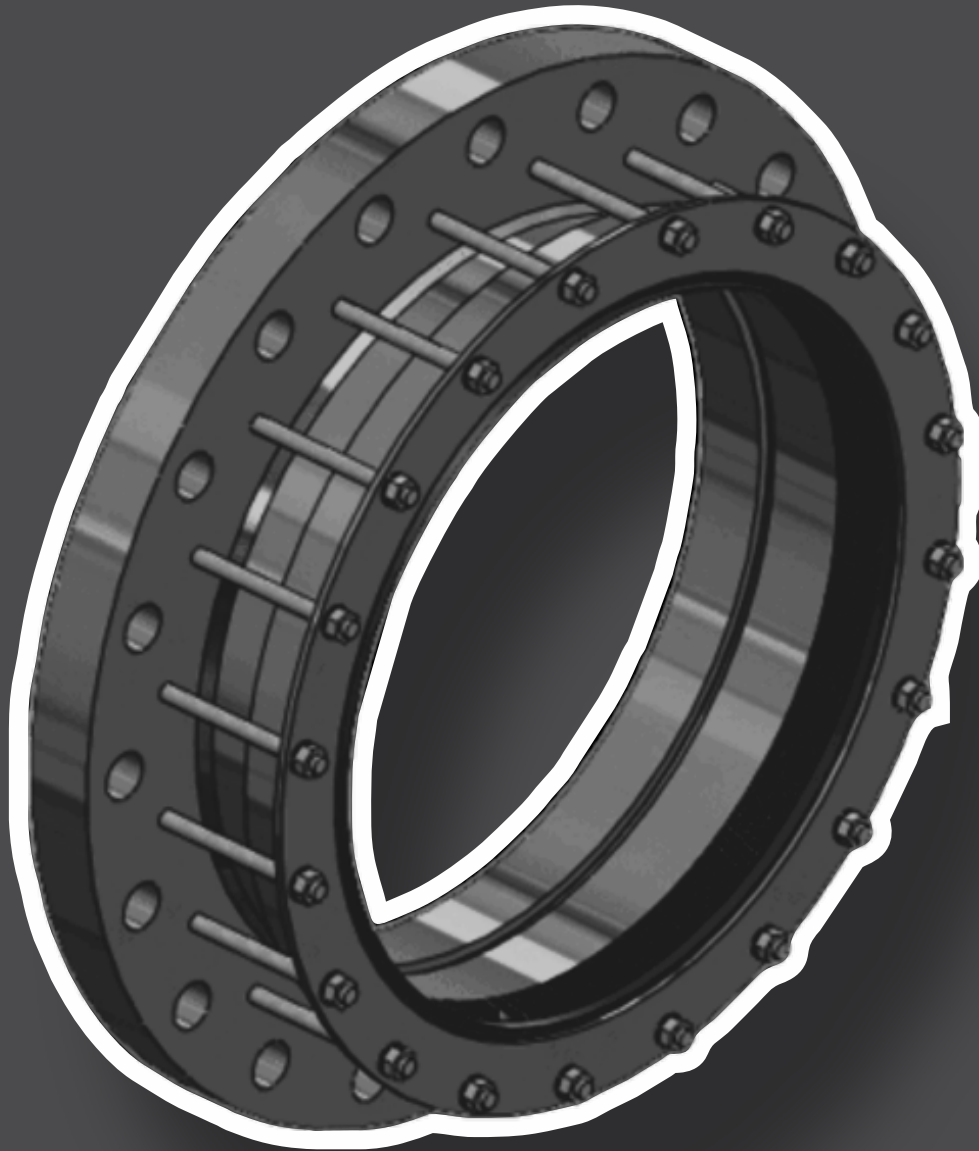

**WIDE RANGE
FLANGE ADAPTERS
TECHNICAL DATA**

Application

Flange Adapters are used to connect plain ended pipes to flanged pipeline components. These products are available with the same wide range end rings and gaskets that allow pipes of a wide range of diameters to fit a single flange adapter. They are suitable for use in water, sewer, air and water pipelines. Any flange drilling and pressure rating can be specified up to 40 bar.

Range

WELBRO Steel Flange Adapters are available from 50mm to 600mm. Larger sizes can be accommodated upon request. WELBRO Steel Flange Adapters are available in the same wide range tolerance as WELBRO Wide Range Couplings.

Angular Deflection

For pipe sizes between 50mm and 450mm:

- Angular deflections of up to 3 degrees.

For pipe sizes between 500 to 600mm:

- Angular deflection of up to 2.5 degrees.

Pipe Setting Gap

For couplings up to 250mm nominal bore, a minimum setting gap of 16mm will be required. The setting gap may not exceed 32mm.

For couplings between 300mm and 600mm nominal bore, a minimum setting gap of 20mm will be required. The setting gap may not exceed 40mm.

Pressure Rating

WELBRO Flange Adapters up to 600mm are designed for a standard working pressure of 16 bar, and a test pressure of 24 bar. Larger pressure ratings can be accommodated upon request.

Temperature

WELBRO Flange Adapters can be used in applications of between -40°C and 90°C, but are not recommended for use in heating systems

Location

Above or below ground, subject to certain limitations according to product type and pipe material. Factories or any other pipe installation such as pump stations or treatment plants.

Lateral Displacement

Couplings are not designed to accommodate lateral displacement, and proper pipe alignment is critical for a successful coupling installation.

Pipe End Preparation

In order to ensure proper sealing and operation of an WELBRO Flange Adapters, the pipe ends must be properly prepared to ensure that the pipe is smooth, clean, without grooves, weld beads or other protrusions or irregularities. This must be for a distance of at least 100mm for nominal bores up to 250mm, and 160mm for nominal bores above 250mm. Also ensure that the pipe is properly round as site handling often leads to pipe ovality

Expansion and Contraction

The gasket on WELBRO Couplings allows for a significant amount of pipe movement due to thermal expansion and contraction. Up to 9mm of movement can be accommodated on a mechanical coupling without affecting sealing performance.

.

1. End Rings:

- Mild Steel to BS EN 10025:2004 or Grade CQ

2. Adapter Body:

- Mild Steel to BS EN 10025:2004 or Grade CQ
- Flanges: Full size SABS 1123 -no reduced thickness flanges used

3. Spigot:

- Spigot - Steel to SANS 1431 Grade 300WA

4. Rubber Gasket:

- EPDM Grade E to BS 2494 1990 or SANS974 Related ISO4633

5. Studs:

- Stainless Steel Grade 304 as standard
- Steel to BS970 Grade 070 or Steel to SANS1143 Grade 8.8

6. Coating

- Fusion Bonded Epoxy to SABS 1217 to a minimum thickness of 250 microns or client specifications
- Bolts are hot dip galvanised to SANS 763

7. SABS Standard

- Compliant with SANS1808-2: 2017

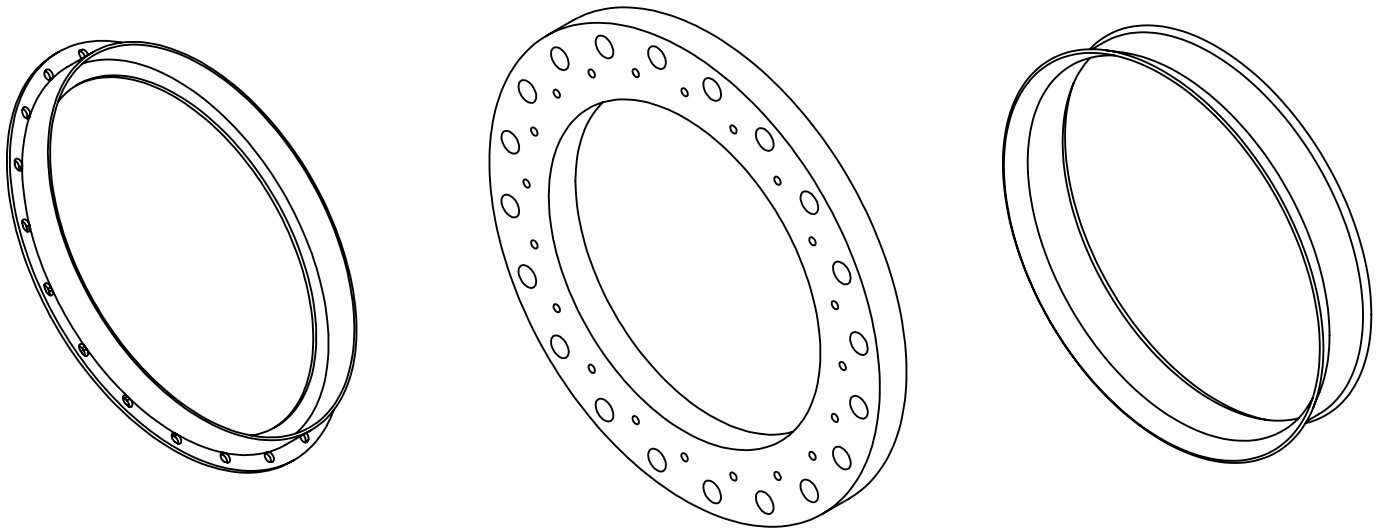

DIMENSIONS

WELBRO FLANGE ADAPTERS

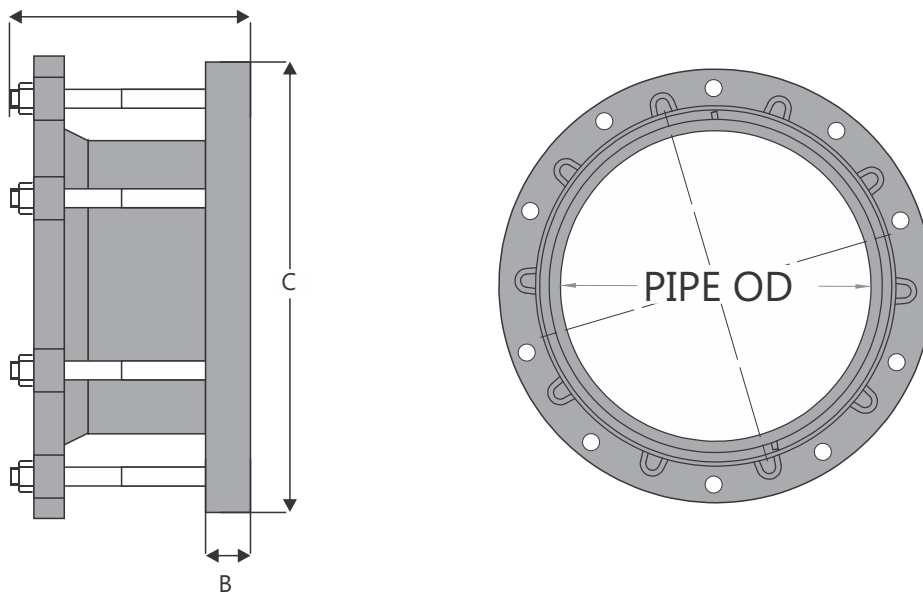

SANS1123

HDG FASTENERS							
NB	ID	Coupling Range	Product Code	Flange			Length A
				Size	Thick (B)	OD (C)	
65	68	57 - 66	WBF0650x50T1000/1600	50	12	165	130
			WBF0650x50T2500/4000	50	20	165	130
70	81	63 - 79	WBF0700x65T1000/1600	65	12	185	130
			WBF0700x65T2500/4000	65	22	185	130
75	95	80 - 93	WBF0750x80T1000/1600	80	14	200	130
			WBF0750x80T2500/4000	80	22	200	130
80	106	88 - 104	WBF0800x80T1000/1600	80	14	200	130
			WBF0800x80T2500/4000	80	22	200	130
100	121	98 - 118	WBF1000x100T1000/1600	100	14	220	130
			WBF1000x100T2500/4000	100	22	250	130
100/2	131	109 - 128	WBF1002x100T1000/1600	100	14	220	130
			WBF1002x100T2500/4000	100	22	250	130
125	156	132 - 154	WBF1250x125T1000/1600	125	16	250	130
			WBF1250x125T2500/4000	125	28	270	130
150	173.5	150 - 170	WBF1500x150T1000/1600	150	18	285	130
			WBF1500x150T2500/4000	150	30	300	130
150/2	191	159 - 187	WBF1502x150T1000/1600	150	18	285	130
			WBF1502x150T2500/4000	150	30	300	130

DIMENSIONS

WELBRO FLANGE ADAPTERS

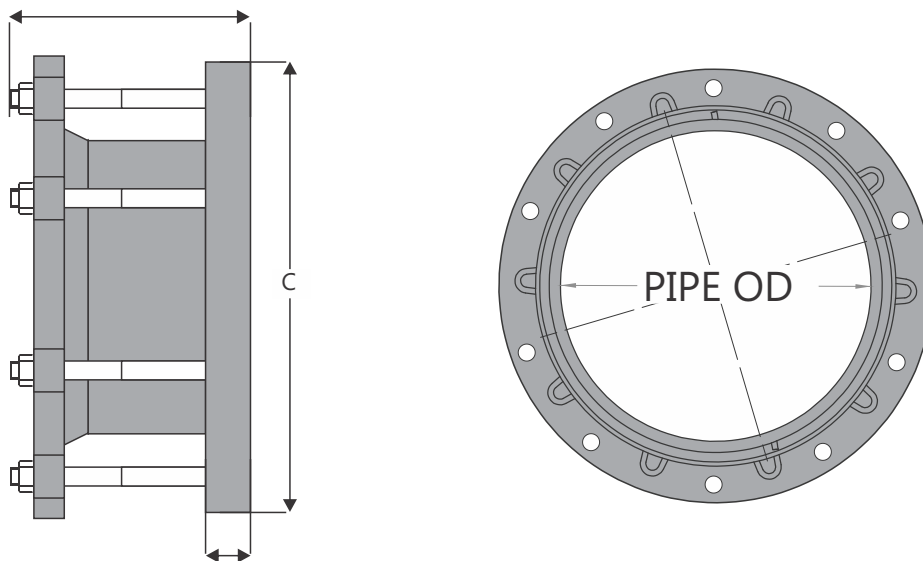

SANS1123

HDG FASTENERS							
NB	ID	Coupling Range	Product Code	Flange			Length A
				Size	Thick (B)	OD (C)	
150/3	202	180 - 200	WBF1503x150T1000/1600	150	18	285	130
			WBF1503x150T2500/4000	150	30	300	130
175	202	192 - 209	WBF1750x200T1000	200	24	340	130
			WBF1750x200T1600	200	26	340	130
			WBF1750x200T2500	200	32	360	130
			WBF1750x200T4000	200	36	375	130
200	210	210 - 223	WBF2000x200T1000	200	24	340	140
			WBF2000x200T1600	200	26	340	140
			WBF2000x200T2500	200	32	360	140
			WBF2000x200T4000	200	36	375	140
200/2	225	228 - 243	WBF2002x200T1000	200	24	340	140
			WBF2002x200T1600	200	26	340	140
			WBF2002x200T2500	200	32	360	140
			WBF2002x200T4000	200	36	375	140
225	245	244 - 253	WBF2250x250T1000	250	20	395	140
			WBF2250x250T1600	250	25	405	140
			WBF2250x250T2500	250	30	425	140
			WBF2250x250T4000	250	38	450	140

DIMENSIONS

WELBRO FLANGE ADAPTERS

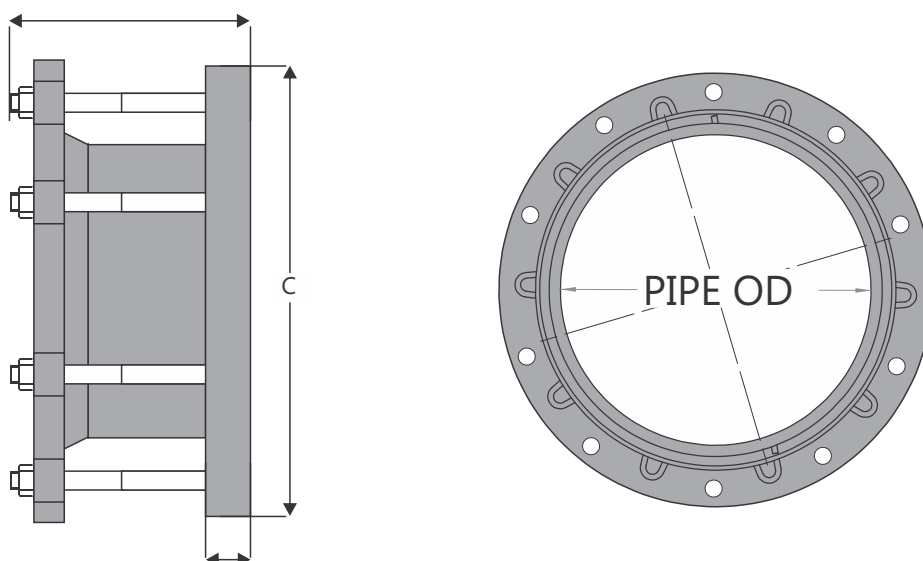

SANS1123

HDG FASTENERS							
NB	ID	Coupling Range	Product Code	Flange			Length A
				Size	Thick (B)	OD (C)	
250	256	268 - 278	WBF2500x250T1000	250	20	395	140
			WBF2500x250T1600	250	25	405	140
			WBF2500x250T2500	250	30	425	140
			WBF2500x250T4000	250	38	450	140
250/2	280	280 - 295	WBF2502x250T1000	250	20	395	140
			WBF2502x250T1600	250	25	405	140
			WBF2502x250T2500	250	30	425	140
			WBF2502x250T4000	250	38	450	140
275	299	302 - 318	WBF2750x300T1000	300	22	445	140
			WBF2750x300T1600	300	28	460	140
			WBF2750x300T2500	300	32	485	140
			WBF2750x300T4000	300	40	515	140
300	321	315 - 328	WBF3000x300T1000	300	22	445	140
			WBF3000x300T1600	300	28	460	140
			WBF3000x300T2500	300	32	485	140
			WBF3000x300T4000	300	40	515	140

DIMENSIONS

WELBRO FLANGE ADAPTERS

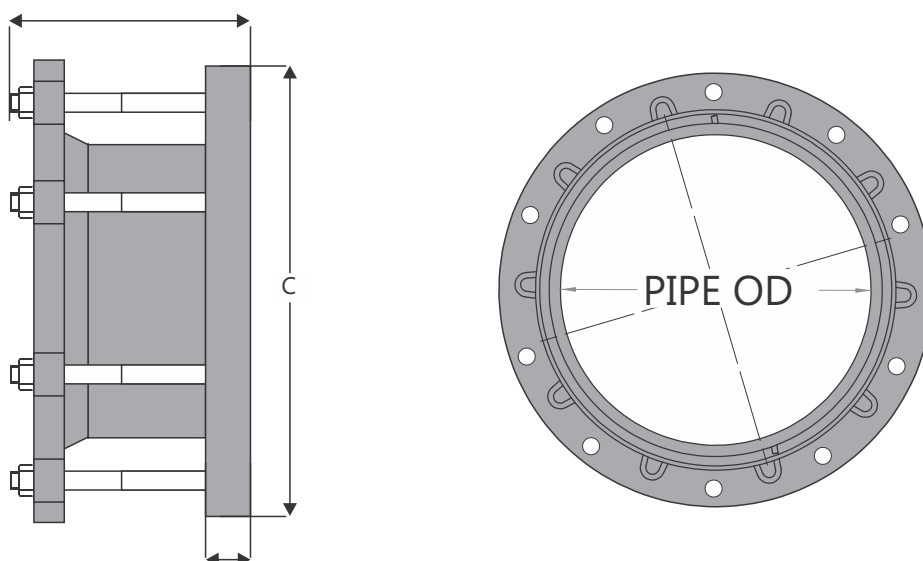

SANS1123

HDG FASTENERS							
NB	ID	Coupling Range	Product Code	Flange			Length A
				Size	Thick (B)	OD (C)	
300/2	354	334 - 350	WBF3002x300T1000	300	22	445	178
			WBF3002x300T1600	300	28	460	178
			WBF3002x300T2500	300	32	485	183
			WBF3002x300T4000	300	40	515	183
300/3	375	356 - 372	WBF3003x300T1000	300	22	445	178
			WBF3003x300T1600	300	28	460	178
			WBF3003x300T2500	300	32	485	183
			WBF3003x300T4000	300	40	515	183
350	363	344 - 360	WBF3500x350T1000	350	25	505	178
			WBF3500x350T1600	350	30	520	178
			WBF3500x350T2500	350	35	555	183
			WBF3500x350T4000	350	45	580	183
350/2	394	374-391	WBF3502x350T1000	350	25	505	178
			WBF3502x350T1600	350	30	520	178
			WBF3502x350T2500	350	35	555	183
			WBF3502x350T4000	350	45	580	183

DIMENSIONS

WELBRO FLANGE ADAPTERS

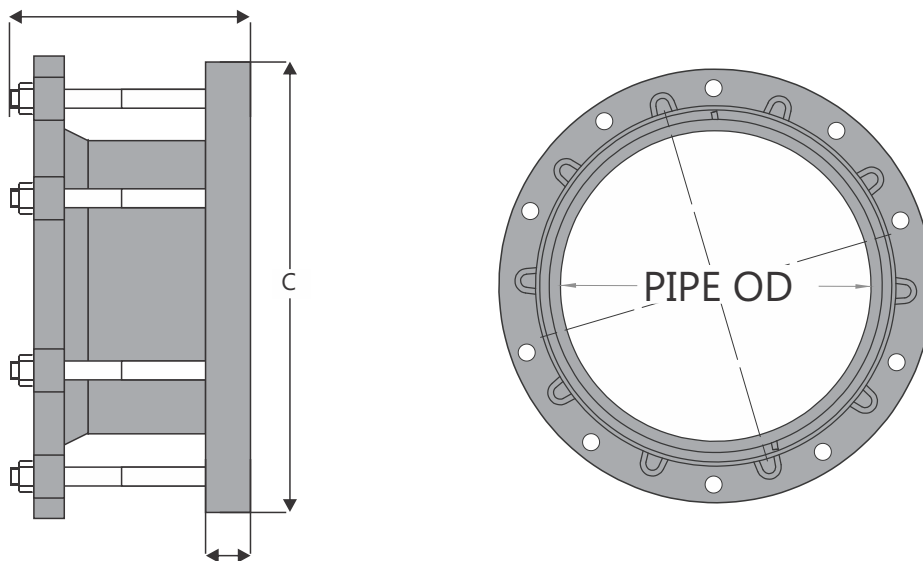

SANS1123

HDG FASTENERS							
NB	ID	Coupling Range	Product Code	Flange			Length A
				Size	Thick (B)	OD (C)	
400	413	391-410	WBF4000x400T1000	400	25	565	178
			WBF4000x400T1600	400	35	580	178
			WBF4000x400T2500	400	40	620	183
			WBF4000x400T4000	400	50	660	183
400/2	421	401-417	WBF4002x400T1000	400	25	565	178
			WBF4002x400T1600	400	35	580	178
			WBF4002x400T2500	400	40	620	183
			WBF4002x400T4000	400	50	660	183
400/3	440	417-437	WBF4003x400T1000	400	25	565	178
			WBF4003x400T1600	400	35	580	178
			WBF4003x400T2500	400	40	620	183
			WBF4003x400T4000	400	50	660	183
400/4	449	430-446	WBF4004x400T1000	400	25	565	178
			WBF4004x400T1600	400	35	580	178
			WBF4004x400T2500	400	40	620	183
			WBF4004x400T4000	400	50	660	183

DIMENSIONS

WELBRO FLANGE ADAPTERS

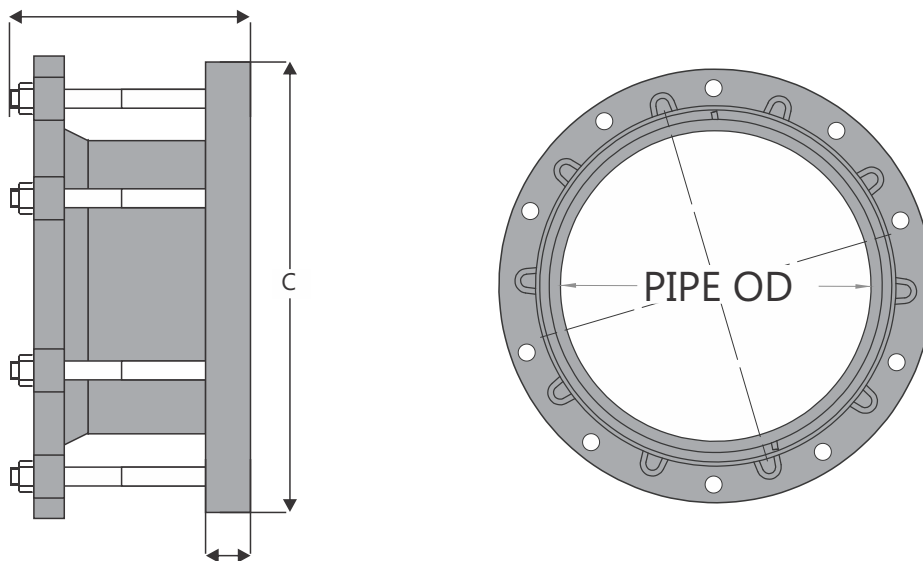

SANS1123

HDG FASTENERS							
NB	ID	Coupling Range	Product Code	Flange			Length A
				Size	Thick (B)	OD (C)	
450	463	444-460	WBF4500x450T1000	450	30	615	178
			WBF4500x450T1600	450	40	640	178
			WBF4500x450T2500	450	45	670	183
			WBF4500x450T4000	450	60	685	183
450/2	478	458-474	WBF4502x450T1000	450	30	615	178
			WBF4502x450T1600	450	40	640	178
			WBF4502x450T2500	450	45	670	183
			WBF4502x450T4000	450	60	685	183
450/3	496	477-493	WBF4503x450T1000	450	30	615	178
			WBF4503x450T1600	450	40	640	178
			WBF4503x450T2500	450	45	670	183
			WBF4503x450T4000	450	60	685	183
450/4	537	518-534	WBF4504x450T1600	450	30	615	178
			WBF4504x450T1600	450	40	640	178
			WBF4504x450T2500	450	45	670	183
			WBF4504x450T4000	450	60	685	183

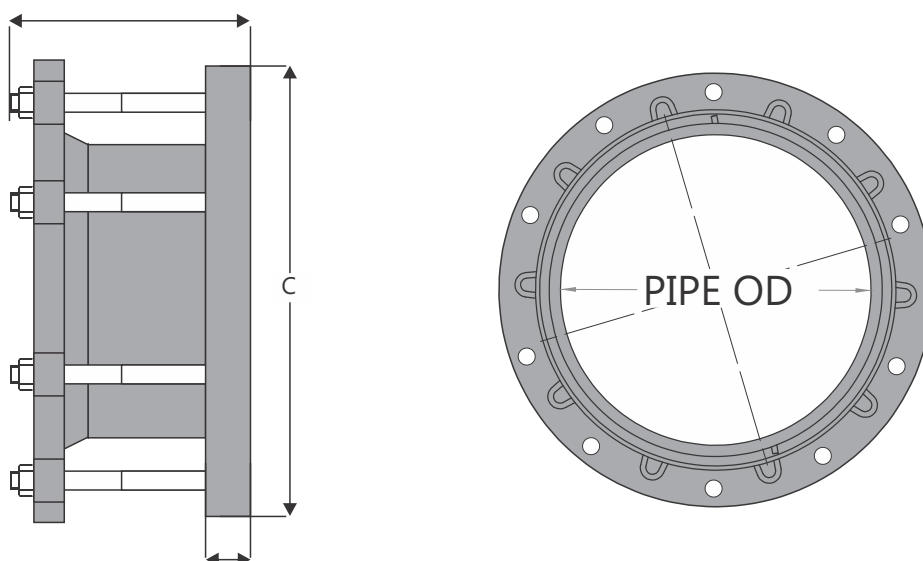

SANS1123

HDG FASTENERS							
NB	ID	Coupling Range	Product Code	Flange			Length A
				Size	Thick (B)	OD (C)	
500	513	494-510	WBF5000x500T1600	500	32	670	178
			WBF5000x500T1600	500	40	715	178
			WBF5000x500T2500	500	50	730	183
			WBF5000x500T4000	500	70	755	183
500/2	549	535-545	WBF5002x500T1600	500	32	670	178
			WBF5002x500T1600	500	40	715	178
			WBF5002x500T2500	500	50	730	183
			WBF5002x500T4000	500	70	755	183
500/3	596	583-593	WBF5003x500T1600	500	32	670	178
			WBF5003x500T1600	500	40	715	178
			WBF5003x500T2500	500	50	730	183
			WBF5003x500T4000	500	70	755	183
550	575	559-571	WBF5500x500T1600	500	32	670	178
			WBF5500x500T1600	500	40	715	178
			WBF5500x500T2500	500	50	730	183
			WBF5500x500T4000	500	70	755	183

DIMENSIONS

WELBRO FLANGE ADAPTERS

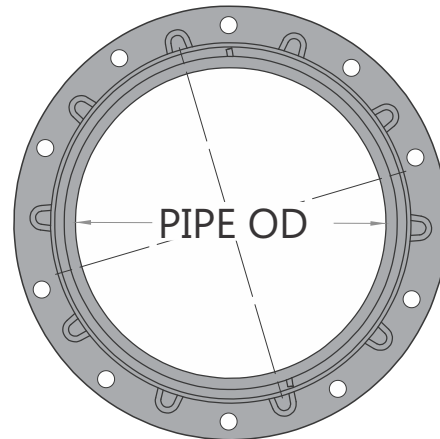
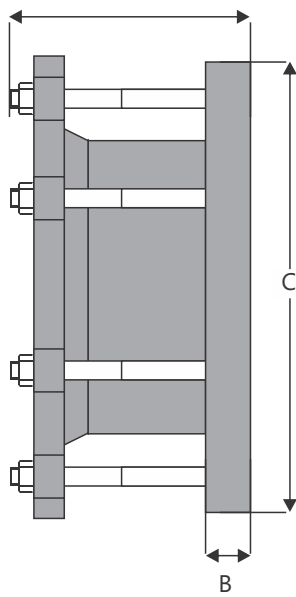

SANS1123

HDG FASTENERS							
NB	ID	Coupling Range	Product Code	Flange			Length A
				Size	Thick (B)	OD (C)	
600	620	606-616	WBF6000x600T1600	600	3	780	178
			WBF6000x600T1600	600	50	840	178
			WBF6000x600T2500	600	60	845	183
			WBF6000x600T4000	600	84	890	183
600/2	642	629-638	WBF6002x600T1600	600	3	780	178
			WBF6002x600T1600	600	50	840	178
			WBF6002x600T2500	600	60	845	183
			WBF6002x600T4000	600	84	890	183

While every effort has been made to ensure that the information in this document is correct and accurate at the time of publishing, WELBRO assumes no responsibility or liability for typographical errors or omissions or of for any misinterpretation of the information contained within the publication and reserves the right to change any information contained herein without notice.

Users of any WELBRO product or information within this document must make their own assessment of suitability for their particular application. Product dimensions are nominal only, and should be verified if critical to a particular installation. No warranty is either expressed, implied, or statutory made by WELBRO unless expressly stated in any sale and purchase agreement entered into between WELBRO and the user.



CONTACT DETAILS

Sales and Distribution

Office: + 27 10 065 1660

Email: sales@welbropipe.co.za

Physical Address

Corner of

Buite and Jacoba Street

Alberton North

Website

www.welbropipe.co.za